

RoHS Compliant

REV.	ECN. NO.	DESCRIPTION	DATE	APPD
X1		ORIGINAL		

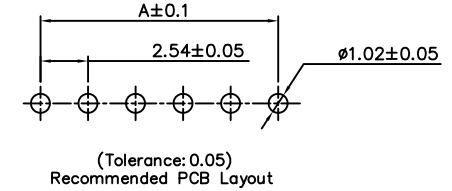

No. of CKTS	Part No.	A	B
02	0225231-022220	2.54	5.08
03	0225231-032220	5.08	7.62
04	0225231-042220	7.62	10.16
05	0225231-052220	10.16	12.70
06	0225231-062220	12.70	15.24
07	0225231-072220	15.24	17.78
08	0225231-082220	17.78	20.32
09	0225231-092220	20.32	22.86
10	0225231-102220	22.86	25.40
11	0225231-112220	25.40	27.94
12	0225231-122220	27.94	30.48
13	0225231-132220	30.48	33.02
14	0225231-142220	33.02	35.56
15	0225231-152220	35.56	38.10
16	0225231-162220	38.10	40.64
17	0225231-172220	40.64	43.18
18	0225231-182220	43.18	45.72
19	0225231-192220	45.72	48.26
20	0225231-202220	48.26	50.80

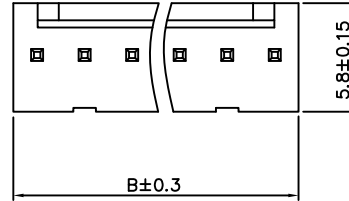
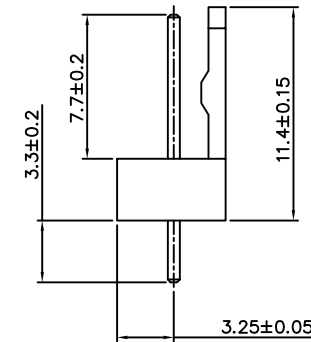
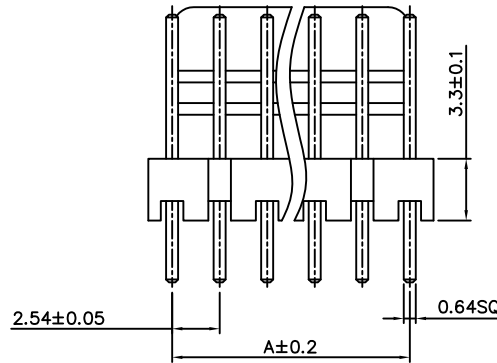

Specifications:
 Rating:
 Current Rating: 3.0 Amp
 Voltage Rating: 250V AC/DC
 Operating Temperature Range: -25°~+85°C

Electrical:
 Contact resistance: 20m Ohm Max
 Insulator resistance: 1000M ohm min.
 Withstanding Voltage: 500V AC/Minute

Material And Finish:
 Insulator: Nylon 66 UL94V-2 Color: Natural
 Contact: Brass
 Plated: Tin Plated

EXTEND USE: mobile phones, digital camera, MP3, MP4, Medical, automotive and aerospace fields			TITLE : 2.54mm Pitch Straight Type Wire to Board Connector		
GENERAL TOLERANCE:		UNIT: mm	MATERIAL:	APPD. : Allen Yang	
LINER: . ±0.30	ANGLES: . ±3°	QTY:	CHKD. : Ann Xu	PART NO. : 0225231-XX2220	
.0 ±0.20	.0 ±2°	FINISHED:	DR. BY. : Jessa Lei 2012.6.28	SHEET: 1/1	SCALE: 1:1
.00 ±0.10	.00 ±1°				A4
.000 ±0.05					